

### Precautions

- ① This product is assistive devices that help the driving safely. Do not drive by rely solely on this product.
- ② The rated voltage of this product is DC 12. And it requires the correct wiring connections and mounting. Please install only by a qualified technician.
- ③ GPS Satellite reception may be unstable in a particular area or some vehicles that have the special tinted windows and electromagnetic interference.
- ④ Please read the manual prudently before using this product. And then use this product correctly.
- ⑤ Please make sure to follow all instruction from manual.
- ⑥ To avoid any risk of electric shock or other injuries, please never disassemble and reassemble this product.
- ⑦ Never feed power to other electronic products by cutting the insulation of the power supply lead of this product and tapping into the lead. The current capacity of the lead will be exceeded, causing overheating.
- ⑧ This product yourself installing or servicing this product and its connecting cables may expose you to the risk of electric shock or other hazards, and can cause damage to this product.
- ⑨ Do not cut the GPS antenna cable to shorten it or use an extension to make it longer. Altering the antenna cable could result in a short circuit or malfunction.
- ⑩ Any function that requires your prolonged attention should only be performed after coming to a complete stop. Always stop the vehicle in a safe location before performing these functions. Failure to do so may result in an accident.
- ⑪ Please remember to wear your seat belt at all the times while operating your vehicle. If you are in an accident, your injuries can be considerably more severe if your seat belt is not properly buckled.
- ⑫ Company can not be held responsible for incidental damages of the driver caused as a result of using the product.

### Full Connection Diagram

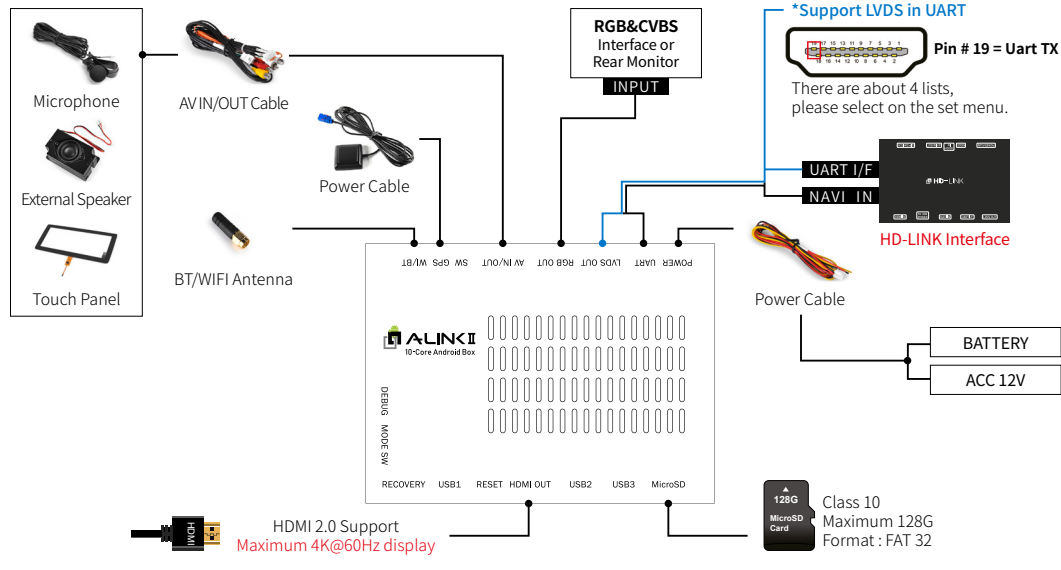

- USB1,2,3 port is supports external keyboard and mouse.
- Do not connect the external hard drive to the USB port.
- Press and hold the **reset button** for 2 seconds to enter the **touch screen calibration**. (Both Resistive and Capacitive touch are available.)
- Press and hold the **reset button** for more than 10 seconds, **the unit will be rebooted**.
- Press and hold the **recovery button** for more than 20 seconds, **the unit will be reset to factory default**.
- The LVDS OUT video output is using the HDMI terminal. But, it is not the HDMI output.
- Use the USB port when updating the firmware.
- You should check the names and colors of each wires exactly, before you connect the wires.
- The product should be powered off before unplugging the HDMI cable.

### Components



### Pin Assignment

#### 01. Power Connector

③	ACC 12V IN	1	HD-LINK ACC 12V IN
②	GND	2	GND
①	BAT (Battery Power)		

#### 02. RGB & CVBS OUT Connector (For Rear Monitor)

⑤	Shield Wire	5	GND
④	Shield Wire GND	6	NC
③	Shield Wire GND	7	NC
②	Red		
①	Green		
	Blue		
	C-Sync		

#### 03. AV IN/OUT Connector

1	Speaker +	2	Speaker -
3	AUX OUT R	4	GND
5	AUX OUT L	6	GND
7	Capacitive Touch SCL	8	GND
9	Capacitive Touch SDA	10	Capacitive Touch 3.3V
11	Capacitive Touch Interrupt	12	Capacitive Touch Reset
13	Touch X-	14	Touch Y-
15	Touch X+	16	Touch Y+
17	UART TX	18	MIC +
19	UART RX	20	MIC -
21	AVIN	22	GND
23	NC	24	FMT ANTENA

### Specifications

OS	Android 7.1.2(Nougat)
CPU	ARM® Cortex™-A72 Core @1.8Ghz (A72 Dual, A53 Quad) Mali-T860 GPU
VPN	H.264/H.265/VP9 up to 4Kx2K@60fps (4K Video)
Memory	2GB LPDDR4
Storage	16GB eMMC, MicroSD Card Slot
USB	USB2.0 High Speed Port x 3
Wireless	2.4GHz WiFi
Signal	802.11a/b/g/n, Bluetooth 4.1
GPS	Ublox8 (GPS/GLONASS/BEIDOU/GALILEO/QZSS/SBAS)
Touch	Resistive and Capacitive touch support
HDMI out	HDMI 2.0, Support maximum 4K@60Hz display
Speaker	2W
FM	88.0Mhz~108.0Mhz
I/O	Stereo Audio Out, Mic (voice recognition), FMT
Voltage	DC 12V ~ 24V
TEMP	Storage -20 C ~ +80 C / Operating -15 C ~ +70 C
Size	146mm(W) x 88mm(H) x 23mm(D)

### Product Warranty

We offer the warranty for 1 year from the date of purchase.

Product Information	Product Name	A-LINK2
	Date of purchase	
	Model Number	
	Serial Number	
Customer Information	Name	
	Contact	
	Address	

#### 1. Free A/S

We will provide free after-sales service within one year from the date of purchase only in case of defects in manufacturing and naturally occurring faults within the warranty period.

If this product is used for any purpose other than its original purpose or for commercial use, the warranty period will be shortened to six months.

#### 2. Paid A / S

- Free A / S warranty period has elapsed.
- Failure caused by customer's negligence or carelessness.
- Defects caused by external factors, not defects in the quality or performance of the product.
- When you want to purchase accessories or consumables separately.
- Failure due to product disassembly.

## Touch Panel Connection

### 01. Capacitive Touch

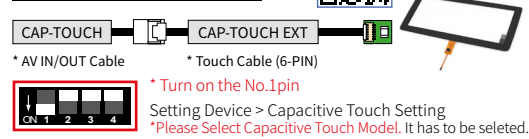

### \* Select Capacitive Touch Model

#### 1. Enter the Device Settings.

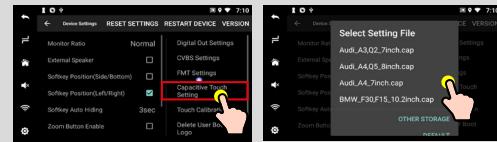

#### 2. Enter Capacitive Touch Setting. 3. Select the correct touch panel.

\* Download additional touch files :  
After download, you can select it in 'Other folder' download folder.

### \* Supports External Mouse

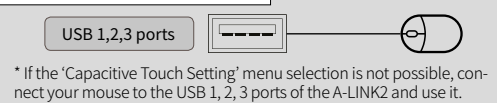

### 02. Resistor Touch

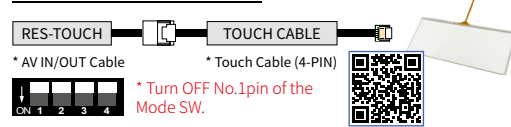

### 03-01. OEM Touch

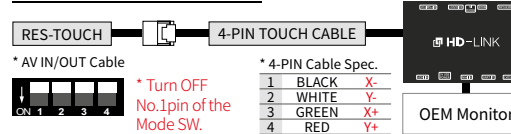

### 03-02. OEM Touch \*LVDS in UART

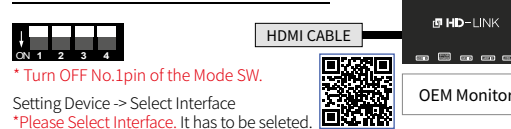

## Dip Switch Setting

\* ON : DOWN / OFF : UP

PIN	OFF	ON
1	Digital LVDS OUT	RGB OUT
2	GPS Fakra (Use The Original GPS Jack By Jack Cable (Option))	External GPS Antenna

PIN	OFF	ON
1	Resistor Touch, UART Touch	Capacitive Touch
2	RGB 800x480	RGB 480x234
3	< Default >	< Special Case >
	IW04-MB14-N IW-NTG55-N23 IW-NTG6-N23 IW-MIB2-N23 IW-PCM5-N23 IW04B-N IW06B-N23	IW-EVO5-N23 IW-EVO6-N23 IW-LR-N23 IW03LX-N23 2019 ES300h IW03V-N23
4	Default	Rotate the Screen 90°
	IW04M IW04A IW04A-4G IW04A3-N IW03T-D IW-F-CR IW-F-SY	IW-F-ML7 IW03GF IW03C-SB IW06C-ML8-D IW03C-EQ-D IW-N-NR

\* Android screen value differs according to interface chipset.  
(Minor differences)

## How to use Hotspot

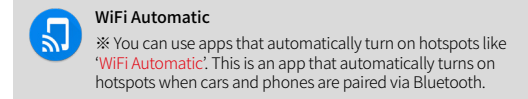
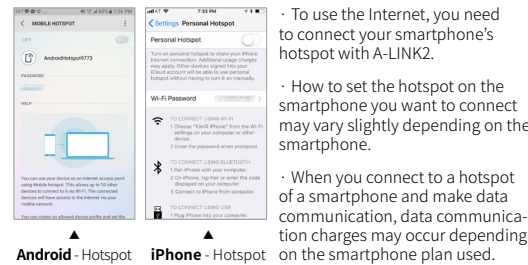

## Touch Calibration \*Both Capacitive and Resistive types are supported.

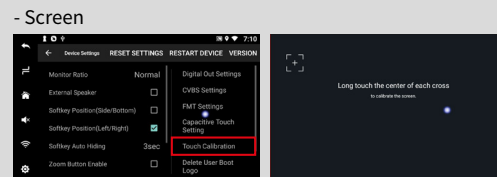

\* Setting Device > Touch Calibration or Presses the "Reset" button 2sec.

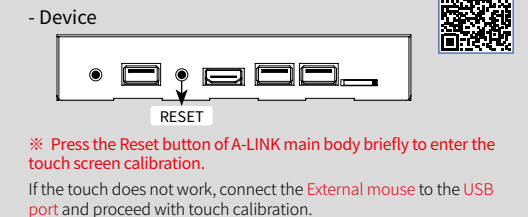

## User Interface

### HOME



- System Bar** Displays the notification contents and status of the device. You can drag down to see a list of quick settings and notifications.
- Quick Bar** Recent App, Home Key, Back, Zoom IN/OUT, Volume
  - \* Press and hold the volume icon, sound is ON or OFF.
  - \* Press and hold the recent app icon, screen will split to the 5: 5 PIP.
  - \* Press and hold the home icon, Google assistant will run.
- Logo** Press and hold to change the logo.
- Widget** Weather and Time are displayed. You can change the widget by holding down the icon.
- Home panel** You can change default app and the wallpaper by holding down the main icons or blank area. And you can move the Home panel area to app drawer by sliding it left.

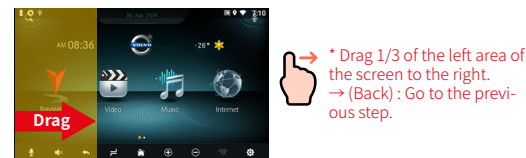

### Change Widget (Time&Weather)

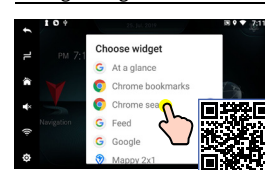

Press and hold the application widget area for about 3 seconds.

### Change Background

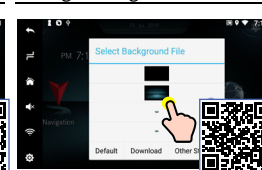

Press and hold the blank area of the main screen for about 3 seconds.

### Change Quick Bar Position

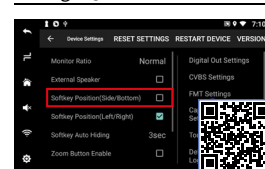

Device settings > Select softkey position (Side & Bottom)

### 5: 5 PIP

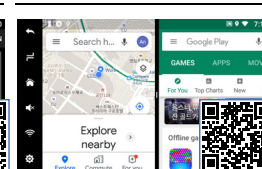

Press and hold the Recent App button of Quick Bar for about 2 seconds.

## User Preferences

### Screen Color, Size, Position

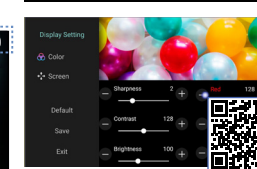

Setting > Display Setting

### FM-TX

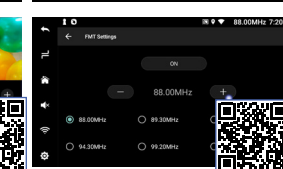

You can hear the sound with car stereo system via FM-TX.

### Font Size

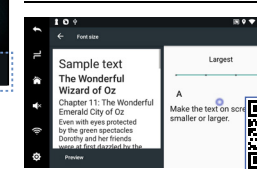

Setting > Display > Font Size

### Display Size

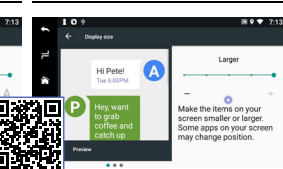

Setting > Display > Display Size

### Change the Boot Logo

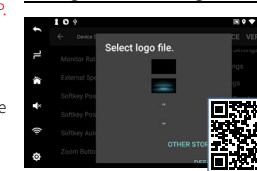

Setting > Boot Logo

## How To Update The Firmware

- A-LINK Setting Device App**
  - Copy the 'system\_a10s' folder to the root of the SD card.
  - Select the 'setting > system update', and press the OK button.
  - After, Enter to screen that to update the firmware. (It will be take 10minutes.)

- A-LINK2 Body**
  - Copy the 'system\_a10s' folder to the root of the SD card.
  - Connect the USB and press the 'Recovery' key of A-LINK for 10 seconds.
  - After, Enter to screen that to update the firmware.



\* After the firmware update is completed, the system will be rebooted. (It will be take 10minutes.)

\* Never turn off the power during the update. If problems occur, please turn off the power and proceed with the update again.

\* After completing the update, please delete the 'system\_a10s' folder not to do update again.

\* You can download the update file from the INDIWORK website.